

altimo

Instruction Manual



Larder Fridge

ALD4802W

Content

1. Safety Information	Page 1~9
2. Overview	Page 10
3. Reverse Door	Page 11~12
4. Installation	Page 13~14
5. Daily Use	Page 15~17
6. Troubleshooting	Page 18
7. Help & Assistance	Page 19
8. Manufacturers' Guarantee	Page 20

Please read this user manual carefully, for your safety and those around you. Reading this manual will ensure correct installation and use. Particularly note hints and warnings.

Make sure all people using this appliance are aware of its workings and safety features. Keep these instructions safe and make sure that they remain with the appliance, especially if it is moved or sold so that everyone using it throughout its life will be properly informed on appliance use and safety.

The manufacturer assumes no responsibility for situations resulting from misuse. For the safety of life and property, you must install, operate, and maintain this appliance as outlined in this user instruction document. The manufacturer is not responsible for damage caused by omission.

Safety of Children and Vulnerable People

- This appliance can be used by children aged from 8 years and above, also people with reduced physical, sensory or mental capabilities or lack of experience and knowledge if they have been given supervision or instruction concerning its safe use and understanding of the hazards involved.
- Children aged from 3 to 8 years can load and unload this appliance following close instruction and mentoring of the guardian.
- Children should be supervised to ensure that they do not play with the appliance.
- Cleaning and user maintenance must not be done by children unless they are aged 8 years and above and with close supervision.
- Keep all packaging well away from children. Packaging carries the risk of suffocation.

Safety information



- At this appliance's end of life, before discarding, isolate the power by removing the socket from the supply. Once the appliance is disconnected the power cable can be cut close to the appliance and the door removed to prevent accidents or being used as a plaything by children.
- This appliance features magnetic door seals, if you are replacing an older appliance with a latch on the door or lid, be sure to make that spring lock unusable before you discard it. This will reduce the risk of accidents with old, discarded appliances.

General safety

WARNING!

Keep ventilation openings, both in the appliance enclosure and in the built-in structure, clear of obstruction.

WARNING!

Do not use mechanical devices or other means to accelerate the defrosting process.

 **WARNING!** Do not use other electrical appliances inside refrigerator appliances, unless they are designed and approved for this purpose by the manufacturer.

WARNING!

The light fitting will get hot when on for long periods.

WARNING!

Do not damage the workings of the appliance

WARNING!

When positioning the appliance, ensure the supply cord is not trapped or damaged.

WARNING!

Do not use multi-socket outlets or portable power supplies to provide power to this appliance.

- Do not store explosive substances such as aerosol cans with a flammable propellant in this appliance.
- The refrigerant isobutane (R-600a) used within the refrigerant circuit of the appliance is a natural gas and flammable.
- During transportation and installation of the appliance, ensure none of the components of the refrigerant circuit become damaged.
 - Avoid open flames and sources of ignition
 - Ventilate the room thoroughly
- It is dangerous to alter the specifications or modify this product in any way. Any damage to the cord may cause a short circuit, fire, and/or electric shock.

This appliance is designed and intended to be used in domestic household environments and similar applications such as staff kitchen areas in shops, offices, and other working environments such as farmhouses, motel rooms, bed and breakfasts.

This appliance is not designed or intended for commercial applications.

Safety information



 **WARNING!** Any electrical components (plug, power cord, compressor, etc.) must be replaced by a certified service agent or qualified service personnel.

 **WARNING!** The light bulb supplied with this appliance is a “special use lamp bulb” usable only with the appliance supplied. This “special use lamp” is not usable for other uses.

- The power cord must not be lengthened.
- Ensure the power plug is not pinched or damaged during installation. A bunched or nipped power cord may overheat and could cause a fire.
- The mains plug of the appliance must be accessible.
- Do not pull the mains cable.
- If the power plug or socket is loose, do not use or insert the power plug. There is a risk of electric shock or fire.
- This appliance is heavy. Use care when moving it.
- Do not touch freezer compartment items with damp hands, this could cause skin abrasions or frost burns.
- Avoid prolonged exposure of this appliance to direct sunlight.

Daily use

- Do not put hot items on the plastic parts of the appliance.
- Do not place food items directly against the rear wall of the storage area.

Safety information



- Storage of food recommendations should be strictly adhered to. Refer to relevant instructions.
- To avoid contamination of food, please respect the following instructions
- Opening the door for long periods can cause a significant increase in the temperature of the storage compartments.
- Clean surfaces in contact with food regularly, and particularly accessible drainage systems.
- Store raw meat and fish in suitable containers inside the refrigerator, so as not to contact or drip onto other food.

Altimo ALD4802W does not have a freezer compartment.

- If the appliance is left empty for long periods, switch it off, defrost, clean, dry, and leave the door partially open to prevent mould from forming within the appliance.

Safety information



Care and cleaning

Before maintenance, switch off the appliance, and disconnect the mains plug from the mains socket.

- Do not clean the appliance with metal objects.
- Never use sharp objects to remove frost from the appliance. Only ever use a plastic scraper.

The creation of condensate is a normal operation of any refrigerator. Moisture is designed to drain through the appliance and condense in a bowl on the warm compressor. Regularly examine the drain hole inside and near the back wall of the refrigerator to ensure it is clear. If necessary, clean the drain hole/channel. If blocked, water will collect in the bottom of the appliance.

Installation

Important! For electrical connection carefully follow the instructions given in specific paragraphs.

- Unpack the appliance and check for damage. Do not connect the appliance if it is damaged. Report possible damages immediately to the retailer. In case of damage retain the packing.

Safety information



- After moving your refrigerator in place, wait at least four hours before connecting the appliance to power. This is to allow the oil to flow back level in the compressor.
- Allow space for adequate air circulation around the appliance, failure to do this could lead to overheating and less efficient operation. To achieve sufficient ventilation follow the instructions relevant to installation.
- The top of your appliance acts as a spacer to maintain a suitable distance from the wall. Warm parts (compressor, condenser) should not be in contact with other surfaces.
- Do not site your refrigerator close to radiators or cookers.
- Make sure that the mains plug is accessible after the installation of the appliance

Service

- Any service or electrical work must be carried out by a qualified electrician or suitably trained person.
- This product must be serviced by an authorized service center, and only genuine spare parts must be used.

Energy Saving

- Do not put hot food in the appliance.
- Do not pack food close together as this prevents air circulation.
- Do not place food touching the back of the compartment(s).

Safety information



- If electricity goes off, don't open the door(s)
Fridge and freezer temperatures are maintained longer if the doors remain closed.
- Don't open the door frequently.
- Minimise the length of time doors are open.
- Maintain the thermostat at a reasonable temperature.
- Keep all accessories and furniture (such as drawers, shelves Balconies) in place, for maintaining the lowest intended design energy consumption.

Environment Protection

 This appliance does not contain gases that could damage the ozone layer, in either its refrigerant circuit or insulation materials. The appliance shall not be discarded together with the urban refuse and rubbish. The insulation foam contains flammable gases: the appliance shall be disposed of according to the appliance regulations to obtain from your local authorities. Avoid damaging the cooling unit, especially the heat exchanger. The materials used on this appliance marked by the symbol are recyclable.



The symbol on the product or on its packaging indicates that this product may not be treated as household waste. Instead, it should be taken to the appropriate collection point for the

 recycling of electrical and electronic equipment. By ensuring this product is disposed of correctly, you will help prevent potential negative consequences for the environment and human health,

which could otherwise be caused by inappropriate waste handling of this product. For more detailed information about the recycling of this product, please contact your local council, your household waste disposal service or the shop where you purchased the product.

Packaging materials

The materials with the symbol are recyclable. Dispose of the packaging in suitable collection containers to recycle it.

Disposal of the appliance

1. Disconnect the mains plug from the mains socket.
2. Cut off the mains cable and discard it safely.



WARNING! During use, service, and disposal of the appliance, please pay attention to this symbol shown to the left. It is located on the rear of the appliance (rear panel or compressor) and is yellow or orange in colour.

It is a risk of fire warning symbol.

There are flammable materials within the refrigerant pipes and compressor.

Overview

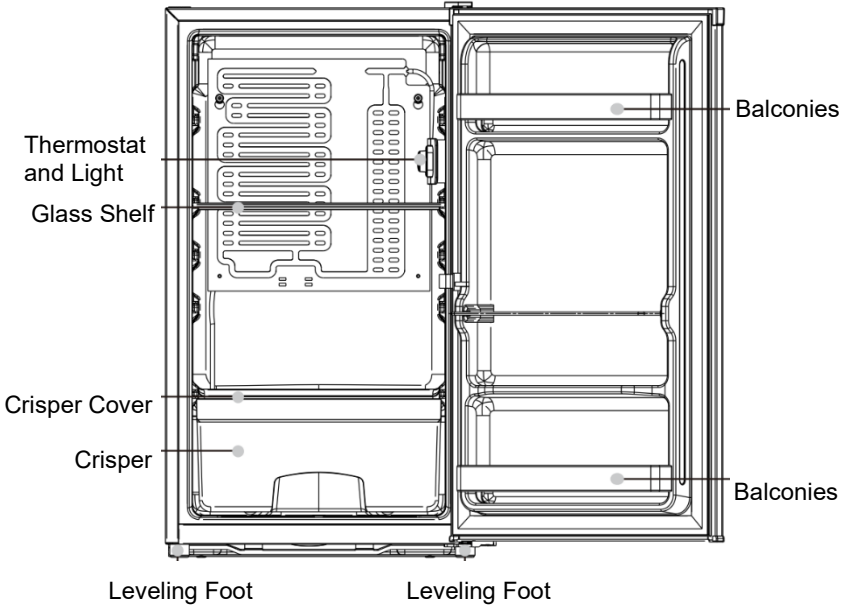

Note: The above picture is for reference only.

Reverse Door

Tool required: Philips screwdriver, Flat-bladed screwdriver, Hexagonal spanner.

- Ensure the unit is unplugged and empty.
- To take the door off, it is necessary to tilt the unit backwards. You should rest the unit on something solid so that it will not slip during the door-reversing process.
- All parts removed must be saved to do the reinstallation of the door.
- Do not lay the unit flat as this may damage the cooling system.
- It's better that 2 people handle the unit during assembly.

1. Remove the hinge cover and then unscrew the hinge bracket.

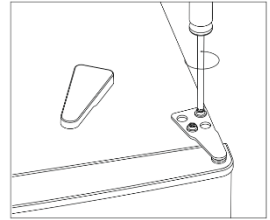

2. Remove the top left screw cover.

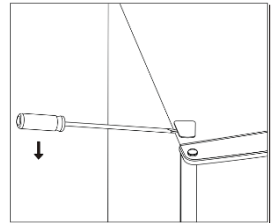

3. Move the top cover from the left side to the right side. And then lift the upper door and place it on a soft surface to prevent it from marking.

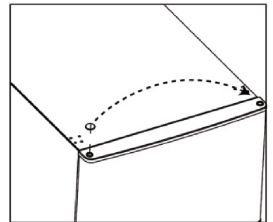

4. Unscrew the bottom hinge. Then remove the adjustable feet from both sides.

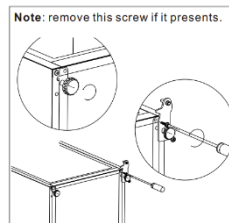

Reverse Door

5. Unscrew and remove the bottom hinge pin, turn the bracket over and replace it.

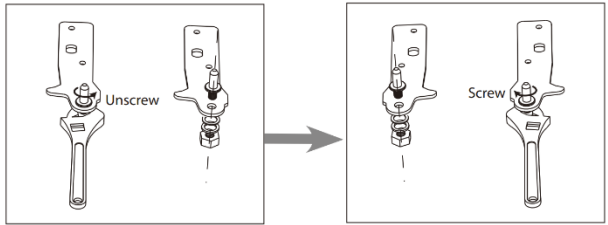

6. Refit the bracket fitting the bottom hinge pin. Replace both adjustable feet.

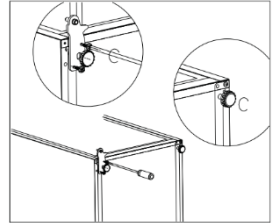

7. Place the door back on. Ensure the door is aligned horizontally and vertically so that the seals are closed on all sides before finally tightening the top hinge. Insert the hinge bracket and screw it to the top of the unit. Use a spanner to tighten it if necessary.

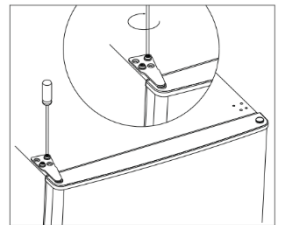

8. Put the hinge cover and the screw cover back.

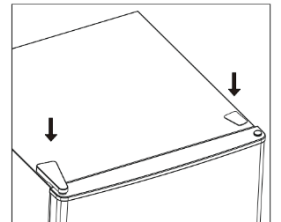

9. Detach the Fridge door gasket and re-attach it after rotating the door.

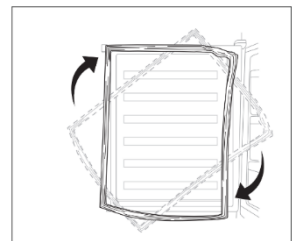

Installation

Install door external handle (only applicable to some models)

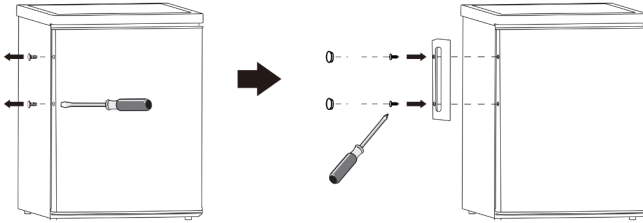

Space Requirement

- Keep enough space for the door to open.

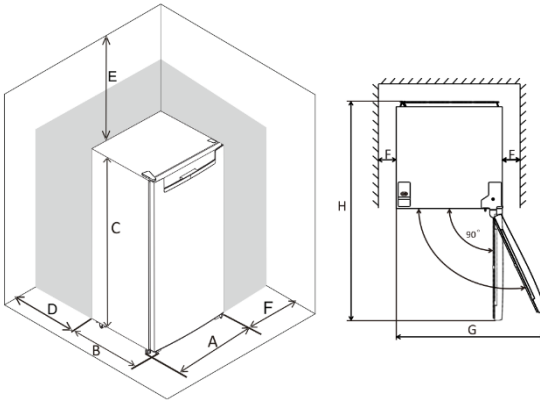

A	480
B	500
C	840
D	Min=50
E	Min=50
F	Min=50
G	820
H	1030

Note: this refrigerating appliance must not be used as a built-in appliance.

Levelling unit

To do this, adjust the two levelling feet in front of the unit.

If the unit is not level, the door s and magnetic seal alignments will not be covered properly.

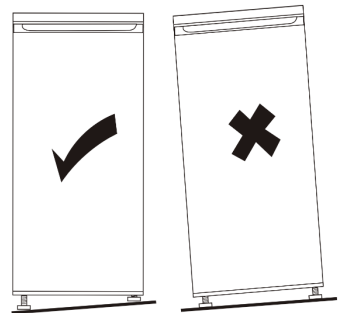
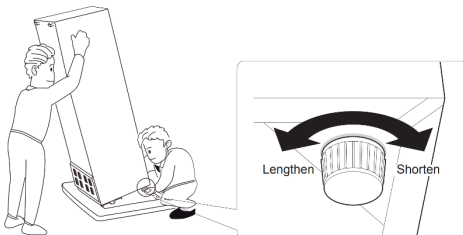

Installation

Positioning

Install this appliance at a location where the ambient temperature corresponds to the climate class indicated on the rating plate of the appliance:

for refrigerating appliances with climate class:

- extended temperate: this refrigerating appliance is intended to be used at ambient temperatures ranging from 10°C to 32 °C; (SN)
- temperate: this refrigerating appliance is intended to be used at ambient temperatures ranging from 16°C to 32 °C; (N)
- subtropical: this refrigerating appliance is intended to be used at ambient temperatures ranging from 16°C to 38 °C; (ST)
- Tropical: this refrigerating appliance is intended to be used at ambient temperatures ranging from 16°C to 43 °C; (T)

Location

The appliance should be installed well away from sources of heat such as radiators, boilers, Direct sunlight etc. Ensure that air can circulate freely around the back of the cabinet. To ensure the best performance, if the appliance is positioned below an overhanging wall unit, the minimum distance between the top of the cabinet and the wall unit must be at least 50mm. ideally, however, the appliance should not be positioned below overhanging wall units. Accurate levelling is ensured by one or more adjustable feet at the base of the cabinet. This refrigerating appliance is not intended to be used as a built-in appliance;

 **Warning!** It must be possible to disconnect the appliance from the mains power supply; the plug must therefore be easily accessible after installation

Electrical connection

Before plugging in, ensure that the voltage and frequency shown on the rating plate correspond to your domestic power supply. The appliance must be earthed. The power supply cable plug is provided with a contact for this purpose. If the domestic power supply socket is not earthed, connect the appliance to a separate earth in compliance with current regulations, consulting a qualified electrician.

The manufacturer declines all responsibility if the above safety precautions are not observed. This appliance complies with the E.E.C. Directives.

Daily use

Temperature setting recommendation

Temperature Setting Recommendation		
Environment Temperature	Freezer Compartment	Fridge Compartment
Summer	/	
		Set on 3~4
Normal	/	
		Set on 3~4
Winter	/	
		Set on 2~3

- The information above gives users recommendations for temperature settings.

Impact on Food Storage

Using the recommended setting, the best storage time for the fridge is no more than 3 days.

Using alternative settings may reduce storage times.

Daily use

Position different food in different compartments according to below table

Refrigerator compartments	Type of food
Door or balconies of fridge compartment	<ul style="list-style-type: none">• Foods with natural preservatives, such as jams, juices, drinks, condiments• Do not store perishable foods
Crisper drawer (salad drawer)	<ul style="list-style-type: none">• Fruits, herbs and vegetables should be placed separately in the crisper bin.• Do not store bananas, onions, potatoes, garlic in the refrigerator
Fridge shelf – middle	<ul style="list-style-type: none">• Dairy products, eggs
Ice Box	<ul style="list-style-type: none">• Foods that do not need cooking, such as ready-to-eat foods, deli meats, leftovers

Daily use

First use

Cleaning the interior

Before using the appliance for the first time, wash the interior and all internal accessories with lukewarm water and some neutral soap to remove the typical smell of a brand-new product, then dry thoroughly.

Important! Do not use detergents or abrasive powders, as these will damage the finish.

Temperature setting

- Plug in your appliance.
- The internal temperature is controlled by a thermostat.
- There are 8 settings. 1 is the warmest setting and 7 is the coldest
- 0 position is to turn off the appliance.
- The appliance may not operate at the correct temperature if the ambient temperature is particularly hot, or the door is opened often.
- This larger refrigerator appliance is not suitable for freezing foodstuffs

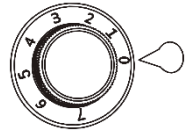

Accessories

Movable shelf

The walls of the refrigerator are equipped with a series of runners so that the shelves can be positioned as desired.

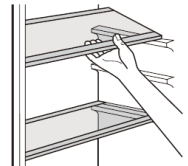

Helpful hints and tips

Hints for fresh food refrigeration

For the best performance:

- Do not store warm food or evaporating liquids in the refrigerator
- Cover or wrap the food, particularly if it has a strong flavour

Hints for refrigeration

Useful hints:

- Meat (all types): wrap in polythene bags and place on the glass shelf above the vegetable drawer. For safety, store in this way only one or two days at the most.
- Cooked foods, cold dishes, etc. These should be covered and may be placed on any shelf.
- Fruit and vegetables: should be thoroughly cleaned and placed in the vegetable drawer.
- Butter and cheese: should be placed in airtight containers or wrapped in aluminium foil or polythene bags to exclude as much air as possible.
- Milk bottles: these should have a cap and should be stored in the bottle rack on the door.
- Bananas, potatoes, onions, and garlic, if not packed, must not be kept in the refrigerator.

Important! Ethereal oils and organic solvents can attack plastic parts, e.g. lemon juice or the juice for orange peel, butyric acid, cleanser that contains acetic acid.

- Keep these substances away from your appliance's parts.

Troubleshooting

Cleaning



- For hygienic reasons the interior, including accessories, should be cleaned regularly.

Caution! The appliance must not remain connected to the mains during cleaning.
Danger of electric shock!

Before cleaning, switch the appliance off and remove the plug from the mains

- Remove the food from the freezer. Store them in a cool place, well covered.
- Never clean the appliance with a steam cleaner. Moisture could accumulate in electrical components. Danger of electrical shock! Hot vapour can lead to damage to plastic parts.
- Clean the appliance and the interior accessories with lukewarm water and cloth.
- Do not use any abrasive cleaners.
- After cleaning wipe with fresh water and rub dry
- The appliance must be dry before it is plugged back in and placed back into service.

Important! Ethereal oils and organic solvents can attack plastic parts, e.g. lemon juice or juice , orange peel, butyric acid, cleanser that contain acetic acid.

- Do not allow such substances in contact with the appliance's parts.

Replace the lamp



Caution! Before replacing the lamp, the appliance must be turned off.

Lamp specification is listed on the appliance rating label.

Follow the process below to replace the lamp:

1. Unplug the appliance to make sure it is disconnected from the mains power supply.
2. Set the temperature control knob to '0' (off).
3. Remove the screw from the lamp cover.
4. Pull the lamp cover out.
5. Unscrew the lamp (anticlockwise).
6. Fit the new lamp (clockwise).
7. Replace the lamp cover and screw.
8. Plug in the appliance and regulate the control knob to the previous position.



Help and assistance

If you require any technical guidance or find that your fridge freezer is not operating as intended, a simple solution can often be found in the **Troubleshooting** section of these instructions or online at www.altimo.co.uk

If you still require further assistance, call one of our experts on **0330 041 7490**. To help us give you a fast and efficient service please have the following information ready:

Model Ref.
(found on a metal plate or sticker on the rear of your appliance)

Serial no.

Date of purchase
(found of your receipt)

Local call rates apply*

Lines open 9.00am-5:00pm Monday to Friday.

*Calls to enquiry lines may attract a charge and set up fee from residential lines depending on your call plan/tariff. Mobile and other providers costs may vary, see www.bt.com/pricing for details.

For Security and training purposes, telephone calls to and from customer service centres may be recorded and monitored. Calls from Republic of Ireland will attract international call charges.

Manufacturers Guarantee

Your appliance has the benefit of a comprehensive manufacturer's guarantee which covers the cost of repair due to mechanical or electrical breakdown.

Any claim during the period of the guarantee must be accompanied by proof of purchase.

The appliance must be correctly installed and operated in accordance with the manufacturer's instructions.

Your appliance is intended for normal domestic use and not for commercial operations.

This guarantee does not cover cosmetic issues with the appliance or failures caused by accidental damage, misuse or alternations which are likely to affect the appliance.

The guarantee is invalid if the product is tampered with or repaired by any unauthorised person.

What to do if you need to report a problem:

1. Please ensure you have ready:
 - The product model ALD4802W and serial number
 - Your full contact details
2. Call the specialist Service Line for your product: **01759 487835**

This guarantee in no way affects your statutory or legal rights.

Any information provided to us for the purposes of product support is subject to our privacy policy, which can be viewed online at www.altimo.co.uk/privacy-policy

For customer service call: 0330 041 7490

 **altimo**