



Instruction Manual



50/50 Freestanding Fridge Freezer

AFF173552W

Contents

Safety Information	3
Product Overview	6
Installation	7
Reversible door	7
Space requirement	10
Levelling the unit	10
Positioning	11
Location	11
Electrical connection	11
Daily Use	12
First use	12
Temperature setting	12
Accessories	13
Helpful Hints and Tips	14
Troubleshooting	16
Product Fiche	17
Help and Assistance	18
Your Appliance Guarantee	19
Disposal	20



Safety information

Important - Please read these instructions fully before installing or operating

Please read this user manual carefully before installation and first use of the appliance, particularly warnings but also hints. To avoid unnecessary mistakes and accidents, it is important to ensure that all people using the appliance are thoroughly familiar with its operation and safety features. Keep these instructions and make sure that they remain with the appliance if it is moved or sold, so that everyone using it through its life will be properly informed on the appliance use and safety. For the safety of property and users, ensure the information within this document is adhered to. The manufacturer is not responsible for damages caused by omission.

Children and vulnerable people safety

- This appliance can be used by children aged from 8 years and above and persons with reduced physical, sensory or mental capabilities, or lack of experience and knowledge if they have been given supervision or instruction concerning use of the appliance in a safe way and understand the hazards involved.
- Children aged from 3 to 8 years are allowed to load and unload this appliance.
- Children should be supervised to ensure that they do not play with the appliance.
- Cleaning and user maintenance should not be undertaken by children under the age of 8 years, and never without supervision.
- Keep all packaging well away from children. There is risk of suffocation.
- If you are discarding the appliance, remove the plug from the power socket, cut the connection cable (as close to the appliance as you can), and remove the door. This is to prevent children playing with a potentially dangerous item, including electric shock or entrapment.
- For older appliances with a spring lock (latch), the latch should be disabled at end of use before being discarded to prevent it from becoming dangerous for children.



General safety

WARNING!

- Maintain the required ventilation space around the appliance or any built-in structure, they must remain clear of obstructions.
- Do not use tools or mechanical devices or any other means to accelerate the defrosting process, only method recommended by the manufacturer.
- Do not damage the refrigerant circuit.
- Do not use other electrical appliances inside of refrigerating appliance (such as ice cream makers) unless they are designed and approved for this purpose by the manufacturer.
- Do not touch the light bulb if it has been on for a long period of time because it could be very hot.
- When positioning the appliance, ensure the supply cord is not trapped or damaged.
- Do not locate the multiple portable socket-outlets or portable power suppliers at the rear of the appliance.
- Do not store explosive substances such as flammable propellant aerosol cans within this appliance.
- The refrigerant contained within the circuit of this appliance (isobutane R-600a) is a natural gas with a high level of environmental compatibility but is nevertheless flammable.
- During transportation and installation of the appliance, take great care not to damage the refrigerant circuit or its components. If damage happens:
 - Avoid open flames and sources of ignition
 - Thoroughly ventilate the room/area where the appliance is situated
- It is dangerous to alter the specifications or modify this product in any way.
- Any damage to the cord has the potential to cause a short circuit, fire and/or electric shock
- This appliance is intended to be used in a domestic setting
- Any electrical components (plug, power cord, compressor etc.) must be replaced by a certified service agent or qualified service personnel.

WARNING!

- The light bulb supplied with this appliance is a specialist type usable only with the appliance supplied, it is not suitable or usable for other settings.
- The power cord must not be lengthened.
- Ensure the power chord is not squashed, nipped, or damaged by moving the appliance into place. A squashed or damaged power plug may overheat and cause a fire.
- Make sure that you can access the mains plug of the appliance if necessary.
- Do not pull at the mains cable.
- If any aspect of the power plug or socket is loose, do not insert the power plug. There is a risk of electric shock or fire. You must consult a specialist.
- Do not operate the appliance without a working lamp.
- This appliance is heavy. Care should be taken when moving it.
- Do not remove or touch items from the freezer compartment if your hands are damp/wet, as this could cause skin abrasions or frost/freezer burns.
- Avoid prolonged exposure of the appliance to direct sunlight.

Daily use

- Do not put hot items in or on plastic parts of the appliance.
- Do not place food products directly against the rear wall.
- Do not re-freeze food once it has been thawed out.
- Store pre-packed frozen food in accordance with the frozen food manufacturer's instructions.
- The manufacturer's storage recommendations should be exactly adhered to. Refer to relevant instructions.
- Do not place carbonated / fizzy drinks in the freezer compartment, as building pressure could lead to leaks or explosions, resulting in damage to the appliance.
- Ice products can cause frost burns if consumed straight from the appliance.

To avoid contamination of food, please respect the following instructions:

- Opening the door for long periods can cause a significant increase of the temperature in the compartments of the appliance.
- Regularly clean all food contact surfaces, also the accessible drainage channels.
- Where fitted, clean water tanks if they have not been used for 48h; flush the water system connected to a water supply if water has not been drawn for 5 days.
- Store raw meat and fish in suitable containers in the refrigerator, so that it is not in contact with (or can drip) onto other food.
- If the appliance is left empty for long periods, switch off, defrost, clean, dry and leave the door open to prevent mould developing within the appliance.

Understanding Freezer Star icons

- One-star (-6 degrees ice compartment) - ice making, stores already frozen food up to one week
- Two-star (-12 degrees ice compartment) – stores already frozen food for up to one month
- Three-star (-18 degrees ice compartment) – will keep frozen food safe for up to three months
- Four-star (-18 degrees freezer) – ideal conditions for freezing and storage fresh and pre-cooked food

The freezer section in this appliance, model AFF173552W is four-star.

Care and cleaning

- Before maintenance, switch off the appliance and disconnect the mains plug from the mains socket.
- Do not clean the appliance with sharp or metal objects.
- Do not use sharp objects to remove frost from the appliance - use a plastic scraper.
- Regularly examine the drain channel inside the refrigerator for defrosted water. If necessary, clean the drain. If the drain gets blocked, water will collect in the bottom of the appliance.

Installation

Important! Carefully follow the instructions given in the following paragraphs.

- Carefully unpack the appliance and check for any damages. If any damage is present, do not connect the appliance. Report your findings to your retailer immediately. Please retain all the packing.
- After moving the appliance into place it is advisable to wait at least four hours before connecting the appliance to allow the oil and to settle in the compressor.
- Ensure adequate air circulation around the appliance. Failure to do this could lead to overheating. To achieve sufficient ventilation, follow the instructions.
- Allow space around the appliance to avoid touching or catching warm parts (compressor, condenser) to prevent possible burns.
- The appliance must not be located close to radiators, cookers, or any heat source.
- Ensure the mains plug is accessible.

Service

- Product service or repair should be carried out by a qualified person.
- This product must be serviced by an authorized Altimo agent, and only genuine spare parts must be used.

Energy Saving

- Don't put hot food in the appliance.
- Leave space between items to improve air circulation.
- Make your items do not touch the back of the compartment.
- If the electricity goes off, items will stay cooler if you don't open the door(s).
 - Don't open the door(s) too frequently.
 - Don't keep the door(s) open for too long.
 - All supplies accessories, such as drawers and shelve balconies, should be kept in place for lower energy consumption.

Environment Protection



This appliance does not contain gasses which could damage the ozone layer, in either its refrigerant circuit or insulation materials. The appliance shall not be discarded together with the urban refuse and rubbish. The insulation foam contains flammable gases: the appliance shall be disposed according to the appliance regulations to obtain from your local authorities. Avoid damaging the cooling unit, especially the heat exchanger. The materials used on this appliance marked by the symbol  are recyclable.



The symbol on the product or on its packaging indicates that this product may not be treated as household waste. Instead, it should be taken to the appropriate collection point for the recycling of electrical and electronic equipment. By ensuring this product is disposed of correctly, you will help prevent potential negative consequences for the environment and human health, which could otherwise be caused by inappropriate waste handling of this product. For more detailed information about recycling of this product, please contact your local council, your household waste disposal service or the shop where you purchased the product.

Packaging materials

Materials with the recycling symbol are recyclable.

Dispose of the appropriate packaging in the various applicable recycling containers.

Disposal of the appliance

1. Disconnect the mains plug from the mains socket.
2. Cut off the mains cable and discard it.



WARNING! During use, service, and disposal of the appliance, please pay attention to the symbol highlighted to the left of this paragraph, which is located on the rear of appliance (rear panel or compressor) and yellow or orange in colour. This is the risk of fire warning symbol. There are flammable materials in refrigerant pipes and compressor. Please be far away from any fire source during use, service and disposal.

Overview

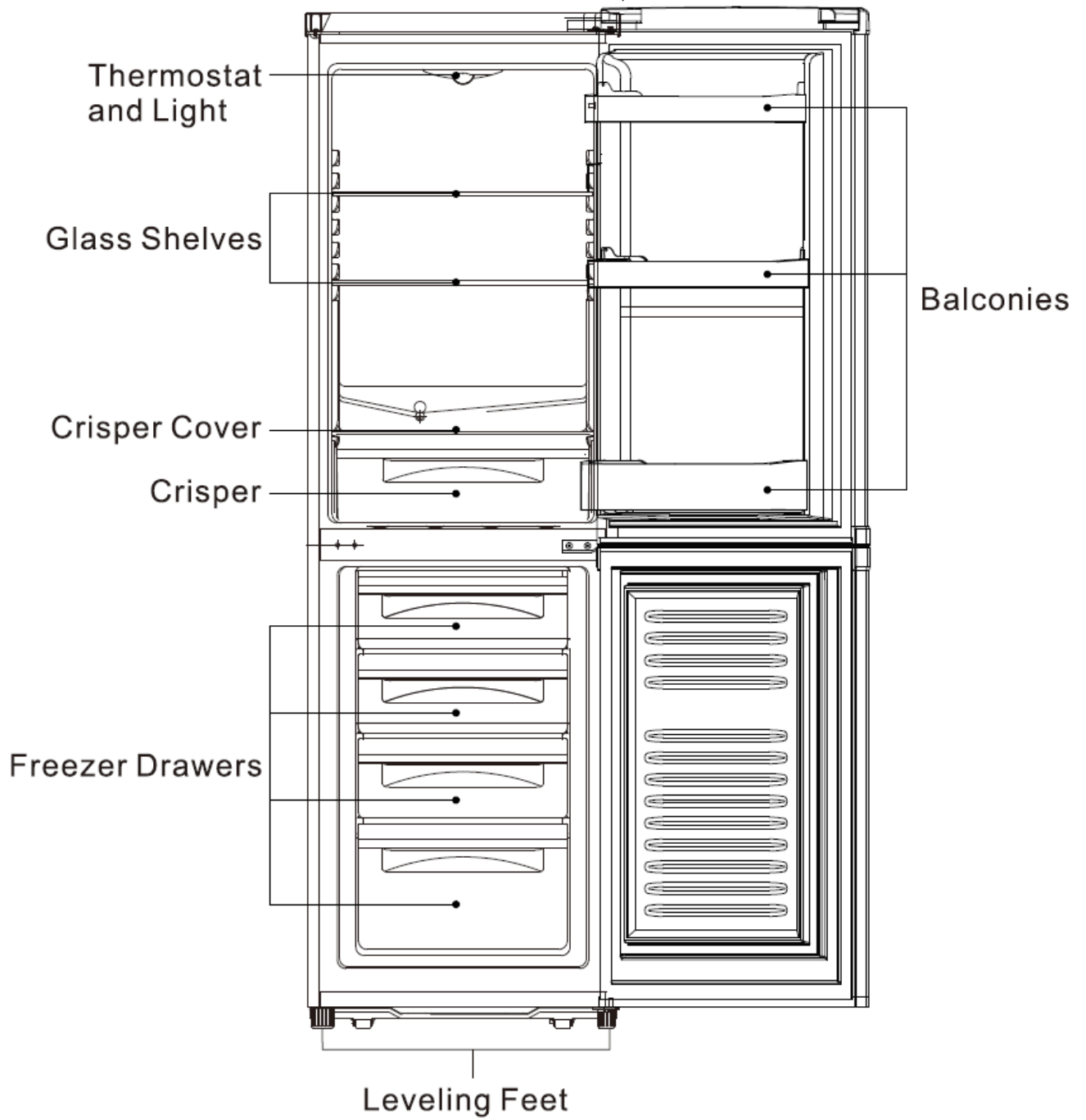

Note: This is an overview image is for guidance only. For accurate detail please check your appliance.

Installation

Reversing the Doors

Tool required: Philips screwdriver, flat screwdriver, hexagonal spanner.

- Before starting, ensure the unit is unplugged and empty.
- To take the door off it is necessary to tilt the unit backwards. Do not lay the unit flat as this may damage the cooling system.
- You should rest the unit on something so that it will not slip during the door reversing process.
- All parts removed must be carefully kept to one side, as everything is re-used to reinstall the door.
- When securing the doors in their new position, it is easier with the help of a second person.

1. Remove the four screws in the top fascia cover and it will come away. Place safely to one side.

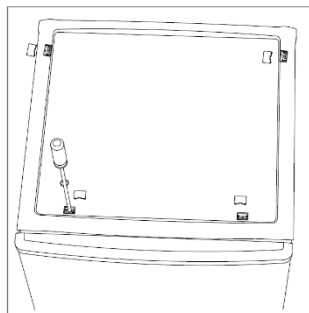

2. Unscrew and remove the top hinge, then the upper door lifts free. Place the door somewhere safe, on a soft surface to avoid scratching.

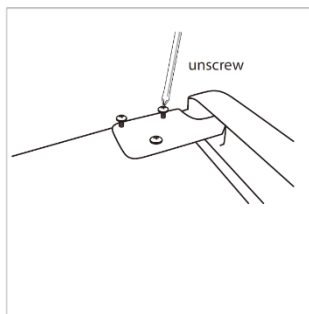

3. Take the top hinge and remove the hinge pin with a screwdriver, flip the hinge bracket, then refit the pin. Ready to fix to the other side. Put it safely to one side for now.

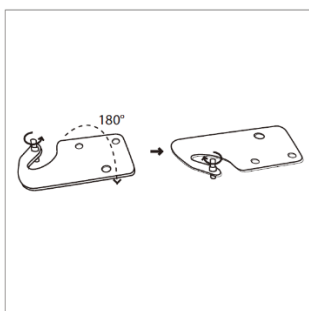

4. Unscrew middle hinge. Then lift lower door out and place it on a soft surface to avoid scratching.

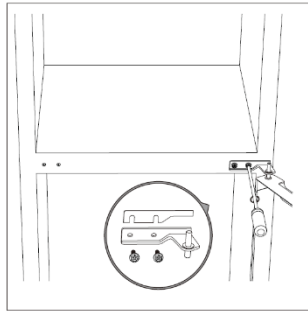

5. Move the hinge hole covers from one side to the other side.

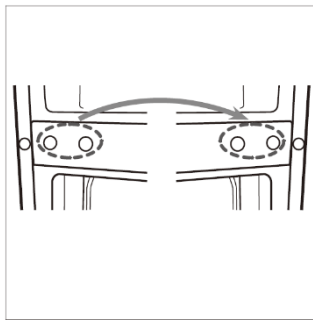

6. Unscrew bottom hinge. Then remove the adjustable feet from both sides.

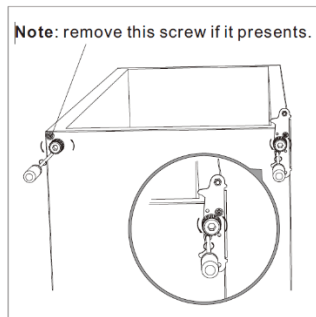

7. Unscrew and remove the bottom hinge pin, turn the bracket over and replace it.

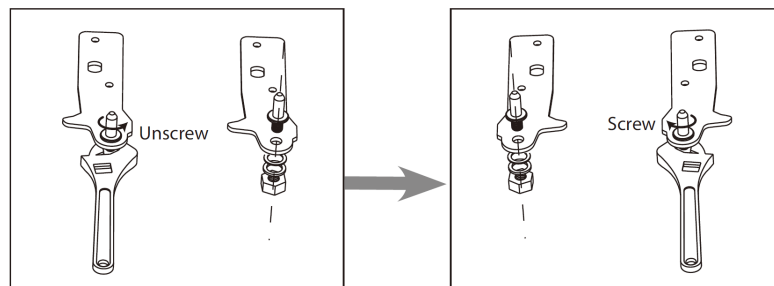

8. Refit the flipped bottom bracket on the other side, the hinge pin will be upward ready to accept the door. Replace both adjustable feet. Place the lower door into its normal closed position.

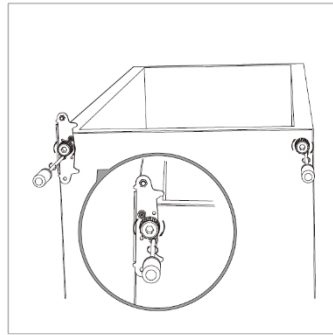

9. Take the recently removed middle hinge. Flip it over. Locate the pin into the hole on the lower door. Secure using the screws that previously held it on the other side. These are the holes that previously had hinge hole covers.

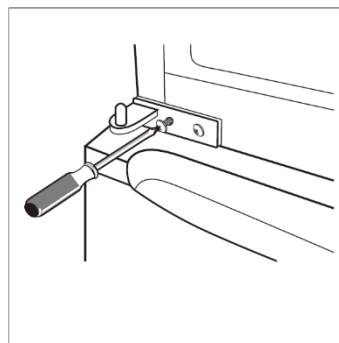

10. Place the upper door back on. Ensure the door hole is located on the hinge pin correctly, also that the door is straight, so the seals are seated properly. Then take the top hinge, insert the hinge pin in the top door hole and tighten the screws to the top of the unit.

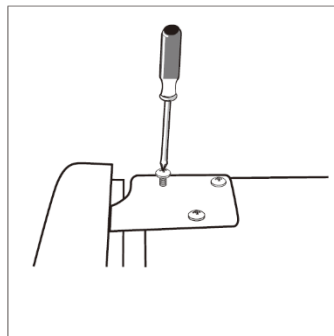

11. Place the top cover on and screw back in place.

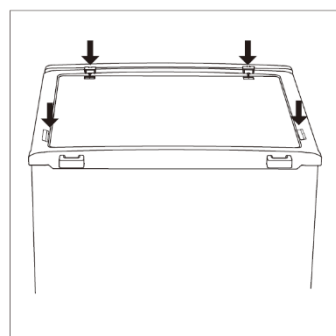

Installation

Space Requirement

- Select a location with level (or nearly level) flooring, refrigerators need a flat surface.
- Select a location without direct exposure to sunlight.
- Select a location with enough space for the refrigerator doors to open easily.
- Allowing space to the right, left, back and top when installing will help reduce power consumption and keep your energy bills lower.
- Keep at least 50mm gap on two sides/ back.

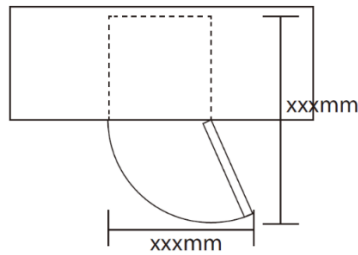

Levelling the unit

It is important to ensure the unit is level, so the doors and magnetic seals align properly. The two front feet on the unit are adjustable levelling feet. Turning the feet anticlockwise extends them.

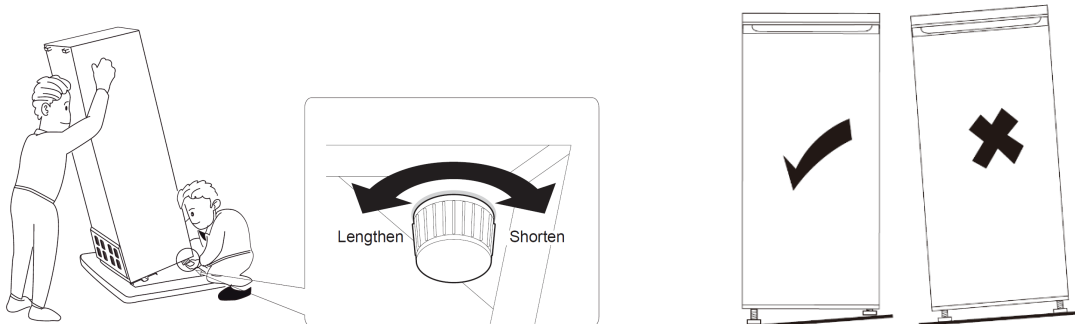

Positioning

Install this appliance at a location where the ambient temperature corresponds to the climate class indicated on the rating plate of appliance:

Understanding refrigerator climate class:

- **SN - Extended temperate:** a refrigerating appliance is intended to be used at ambient temperatures ranging from 10°C to 32 °C
- **N - Temperate:** a refrigerating appliance is intended to be used at ambient temperatures ranging from 16°C to 32 °C
- **ST - Subtropical:** a refrigerating appliance is intended to be used at ambient temperatures ranging from 16°C to 38 °C
- **T - Tropical:** a refrigerating appliance is intended to be used at ambient temperatures ranging from 16°C to 43 °C

Location

- The unit should be installed away from heat sources, such as radiators, boilers, direct sunlight etc.
- Ensure that air can circulate freely around the back of the cabinet.
- This refrigerating appliance is freestanding and not intended to be used as a built-in appliance.
- Ideally the appliance should not be positioned below overhanging wall units. If the appliance is to be positioned below an overhanging wall unit, for best performance the minimum distance between the top of the cabinet and the wall unit must be at least 50mm.
- Accurate leveling is ensured by using the adjustable front feet.



Warning! It must be possible to disconnect the appliance from the mains power supply; the plug must be easily accessible after installation.

Electrical connection

Before plugging in, ensure that the voltage and frequency shown on the rating plate correspond to your domestic power supply. The appliance must be earthed. The power supply cable plug is provided with a contact for this purpose. If the domestic power supply socket is not earthed, connect the appliance to a separate earth in compliance with current regulations, consulting a qualified electrician.

The manufacturer declines all responsibility if the above safety precautions are not observed.

This appliance complies with the E.E.C. Directives.

Daily Use

First Use

Cleaning the interior

Before using the appliance for the first time, wash the interior and all internal accessories with lukewarm water and some neutral soap to remove the typical smell of a brand-new product. Then dry thoroughly.

Important! Do not use detergents or abrasive cleaners, as these will damage the finish.

Temperature Setting

- Plug in your appliance. The internal temperature is controlled by a thermostat. There are 8 settings:
 - 0 - the appliance is switched off
 - 1 - is the warmest setting
 - 7 - is the coldest setting
- The appliance may not operate at correct temperature if:
 - It is in a particularly hot place
 - The door is opened too often
 - The door is prevented from closing properly by food or the appliance not being level

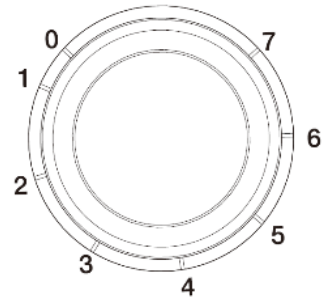

Freezing fresh food

The freezer compartment is suitable for freezing fresh food and storing frozen and deep-frozen food for long periods. When freezing fresh food, place the fresh food to be frozen in the freezer compartment. The maximum amount of food that can be frozen in 24 hours is specified on the rating plate. The freezing process takes 24 hours, during this period do not add other fresh food to be frozen.

Storing fresh food

When first starting-up the appliance or after a period out of use, the appliance needs to cool down to the correct temperature before putting products in the compartment. Let the appliance run at least 2 hours on the highest settings before adding food.

Important! In the event of accidental defrosting, for example the power has been off for longer than the value shown in the technical characteristic chart under “rising time”, the defrosted food must be consumed quickly or cooked immediately and then re-frozen (after cooking).

Thawing

Deep-frozen or frozen food can be thawed in the fridge compartment or at room temperature, depending on the time you have available to do this. Small items may even be cooked from frozen, directly from the freezer. In these cases, cooking will take longer.

Ice-cube tray

This appliance may be equipped with one or more ice-cube tray to produce ice.

Accessories

Movable shelves

The walls of the refrigerator are equipped with a series of channels so that the shelves can be positioned as desired.

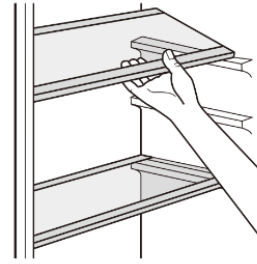

Positioning the door balconies

The door balconies can be removed and, in some cases, repositioned to facilitate storing different sizes. To remove a door balcony, ensure it is empty then carefully lift upwards in the direction of the arrows as shown. It is replaced by lining up and moving downwards until it seats securely.

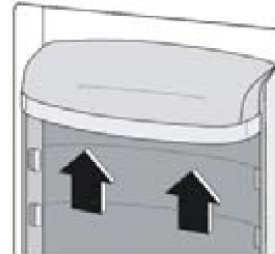

Disassemble the bottom drawer

1. Pull out the bottom drawer to stopper position.
2. Lift up the front of drawer.
3. Pull out the bottom drawer.

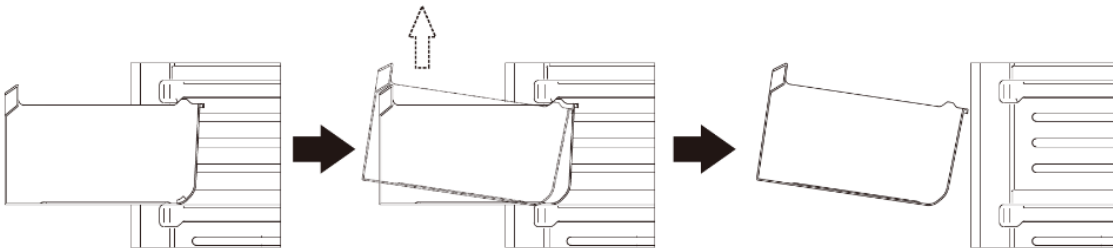

Helpful hints and tips

To help you make the most of the freezing process, here are some important tips:

- The maximum quantity of food which can be frozen in 24 hours is shown on the rating plate.
- The freezing process takes 24 hours. Add no further food to be frozen during this period.
- Only freeze fresh, top quality, thoroughly cleaned foodstuffs.
- Prepare food in small portions to aid rapid freezing and for thawing only the required quantity.
- Wrap food in airtight packages such as aluminum foil, polythene, or plastic tubs.
- Do not allow fresh, unfrozen food to touch already frozen food to avoid raising its temperature.
- Lean foods store better and longer than fatty ones. Salt reduces the storage life of food.
- Ice lollies could cause skin to freeze-burn, if consumed immediately after removal from the freezer.
- Add a note to date the freezing of food to keep tab of the storage time.

Hints for storage of frozen food

To obtain the best performance from this appliance, you should:

- Ensure the commercially frozen foodstuffs were adequately stored by the retailer.
- Ensure that frozen foodstuffs are transferred from store to freezer in the shortest possible time.
- Minimize door opening. Do not leave a door open longer than necessary.
- Once defrosted, food deteriorates rapidly and cannot be re-frozen.
- Do not exceed the storage period indicated by the food manufacturer.

Hints for fresh food refrigeration

To obtain the best performance:

- Meat (all types) - wrap and place on the glass shelf above the vegetable drawer.
 - For safety, store in this way for only one or two days at the most.
- Cooked foods, cold, dishes, etc. - should be covered and may be placed on any shelf.
- Fruit and vegetables - should be thoroughly cleaned and placed in the special drawer(s) provided.
- Butter and cheese - should be placed in airtight containers, wrapped in aluminum foil or polythene bags to exclude as much air as possible.
- Milk bottles - should have a cap and be stored in the door balconies.
- Bananas, potatoes, onions, and garlic - if not packed, should not be kept in the fridge.
- Cover or wrap food, particularly if it has a strong flavour.
- Do not store warm food or evaporating liquids in the refrigerator.

Defrosting the freezer

It is normal operation for the freezer compartment to become progressively covered with ice. Periodically this should be removed.

Never use sharp or metal tools to scrape frost from the evaporator as you could damage it.

If the ice becomes very thick on the inner liner, complete defrosting should be carried out as follows:

- Turn off the power.
- Remove all stored food, wrap it in several layers of newspaper and put it in a cool place.
- Keep the door open. Place a container underneath to collect defrosted water.
- When defrosting is completed thoroughly dry the interior.
- Turn on the power to restart the appliance again.

Cleaning

Clean the appliance interior regularly, including interior accessories.



Caution! The appliance should not be connected to the mains during cleaning.

Danger of electrical shock! Before cleaning, switch the appliance off and remove the plug from the mains, or switch off or turn out the circuit breaker or fuse. Never clean the appliance with a steam cleaner. Moisture could accumulate in electrical components. Hot vapors can lead to the damage of plastic parts. The appliance must be dry before it is placed back into service.

Important! Ethereal oils and organic solvents can attack plastic parts.

e.g. lemon juice or the juice for orange peel, butyric acid, cleansers that contain acetic acid.

Cleaning drain hole

To avoid defrosted water overflowing into the fridge, periodically clean the drain hole at back of fridge compartment. Use an implement to clean the hole as shown in right picture.

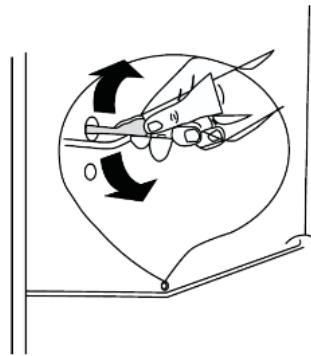

- Do not use any abrasive cleaners.
- Do not allow cleaning substances to touch workings or electronic parts
- Remove the food from the freezer. Store them well covered in a cool place.
- Switch off the appliance, remove the plug.
- Clean inside the appliance including the interior accessories with a cloth and lukewarm water. After cleaning wipe with fresh water and thoroughly wipe dry.
- Ensuring everything is dry, the appliance can go back into operation.

Replace the lamp

The internal light is an LED type. To replace the lamp, please contact qualified technician.

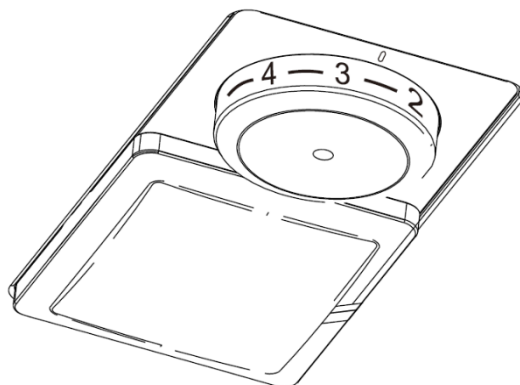

Troubleshooting

Important! There are some sounds that are during normal to hear during use (compressor *whirring*, refrigerant circulation *gurgling*).



Caution! Before trying to resolve any issues, disconnect the power supply.

Only a qualified electrician or competent person should attempt to fix any issues not listed in this manual.

Problem	Possible Cause	Solution
Appliance does not work	Temperature regulation knob is set at number "0".	Set the knob at another number to switch on the appliance.
	Mains plug is not plugged in or is loose	Insert mains plug
	Fuse has blown or is defective	Check fuse, replace if necessary
	Socket is defective	Mains malfunctions are to be corrected by an electrician
The food is not frozen enough	Temperature is not properly adjusted	Please look in the initial Temperature Setting section
	Door was open for an extended period	Open the door only as long as necessary
	A large quantity of warm food was placed in the appliance within the last 24 hours	Turn the temperature regulator to a colder setting temporarily
	The appliance is near a heat source	Please look in the installation location section
Appliance cools too much	Temperature is set too cold.	Turn the temperature knob to a warmer setting temporarily.
Unusual noises	Appliance is not level	Re-adjust the feet
	The appliance is touching the wall or other objects	Move the appliance slightly
	A component, e.g. a pipe, on the rear of the appliance, is touching another part of the appliance or the wall	If necessary, carefully move the component out of the way
Water on the floor	Water drain hole is blocked.	See the cleaning section.
Side panels are hot	This is normal, the heat exchanger is located in the side panels.	Wear gloves to touch side panels if needed

If the malfunction persists, contact the Service Center.

Product Fiche

BRAND	ALTIMO
MODEL NUMBER	AFF173552W
PRODUCT DESCRIPTION	50:50 FRIDGE FREEZER STATIC
PRODUCT COLOUR	WHITE
DOOR OPENING DIRECTION	RIGHT (STANDARD)
DOOR REVERSIBLE	YES
INSTALLATION - FREE STANDING	YES
PRODUCT WIDTH	55 CM
COOLING SYSTEM	STATIC
DEFROSTING SYSTEM	MANUAL
CONTROL SYSTEM	ELECTRONIC
ANNUAL ENERGY CONSUMPTION - kWh	217
AIRBOURNE ACOUSTICAL NOISE EMISSIONS	40
NOISE LEVEL CLASS	C
STAR RATING	4
ENERGY EFFICIENCY CLASS - NEW STANDARD	E
CLIMATE CLASS	N/ST
REFRIGERATING GAS	R600a
CERTIFICATION	CE/GS/CB/UKCA
POWER CABLE TYPE	UK
POWER CABLE LENGTH	1.6
VOLTAGE/FREQUENCY	220-240V ~ 50HZ
PACKING TYPE	CARTON (STANDARD)
PACKAGING PRINTED	YES
DOOR HANDLE DESIGN	INTEGRATED
FULL METAL BACK	YES
DOOR SEAL COLOUR	WHITE
LED INTERIOR LIGHT	YES
EGG TRAY	YES
ICE TRAY	YES
ACCESSORY COLOUR	TRANSPARENT
DOOR BALCONIES	YES
CRISPER DRAWERS	1
FREEZER DRAWERS	4
GLASS SHELVES	2
ADJUSTABLE LEVELLING FEET	YES/WHEEL
LOGO TYPE	METAL EFFECT
NAME PLATE LANGUAGE	ENGLISH
PACKAGE LABEL TYPE	STANDARD
PACKAGE LABEL LANGUAGE	ENGLISH
ENERGY LABEL TYPE	STANDARD
ENERGY LABEL LANGUAGE	ENGLISH
EAN CODE	0745125572604
INSTRUCTION MANUAL LANGUAGE	ENGLISH
FRIDGE STORAGE VOLUME NET	138
FREEZER STORAGE VOLUME NET	110
STORAGE TIME DURING POWER-OFF (HOURS)	10.5
FREEZING CAPACITY IN 24 HOURS (KG)	5
NET WEIGHT (KG)	52
GROSS WEIGHT (KG)	56
PRODUCT DIMENSIONS W X D X H (mm)	550 X 570 X 1720
PACKAGING DIMENSIONS W X D X H (mm)	575 x 605 x 1785
LOADING CAPACITY - 40HC	103

Help and assistance

If you require any technical guidance or find that your fridge freezer is not operating as intended, a simple solution can often be found in the **Troubleshooting** section of these instructions or online at www.altimo.co.uk

If you still require further assistance, call one of our experts on **0330 041 7490**. To help us give you a fast and efficient service please have the following information ready:

Model Ref.	<input type="text"/>	You can find these on the rating plate - a small information panel (usually a sticker or metal plate) on the rear of your appliance.
Serial number	<input type="text"/>	
Date of purchase	<input type="text"/>	This will be shown on your receipt.

Local call rates apply*

Lines open 9.00am-5:00pm Monday to Friday.

*Calls to enquiry lines may attract a charge and set up fee from residential lines depending on your call plan/tariff. Mobile and other providers costs may vary, see www.bt.com/pricing for details.

For Security and training purposes, telephone calls to and from customer service centres may be recorded and monitored. Calls from Republic of Ireland will attract international call charges.

Your Appliance Guarantee

Guarantee Details (UK only)

Your appliance has the benefit of a comprehensive manufacturer's guarantee which covers the cost of repair due to mechanical or electrical breakdown.

Any claim during the period of the guarantee must be accompanied by proof of purchase.

The appliance must be correctly installed and operated in accordance with the manufacturer's instructions.

Your appliance is intended for normal domestic use and not for commercial operations.

This guarantee does not cover cosmetic issues with the appliance or failures caused by accidental damage, misuse or alterations which are likely to affect the appliance.

The guarantee is invalid if the product is tampered with or repaired by any unauthorised person.

What to do if you need to report a problem:

1. Please ensure you have ready:
 - The product model AFF173552W and serial number
 - Your full contact details
2. Call the specialist Service Line for your product: **01759 487835**

This guarantee in no way affects your statutory or legal rights.

Any information provided to us for the purposes of product support is subject to our privacy policy, which can be viewed online at www.altimo.co.uk/privacy-policy

Declaration of conformance to product standards

This appliance conforms to all relevant standards applicable to domestic appliances sold in the UK

Disposal



Refrigerant and cyclopentane foaming materials used within the appliance are flammable. Therefore, it must be kept away from fire to prevent damage to the environment or injury.

Do not dispose this product as unsorted waste. Collection of such waste must be handled separately as special treatment is necessary.

Recycling facilities are now available for all customers at which you can deposit your old electrical products. Customers will be able to take any old electrical equipment to participating sites run by their local councils. Please remember that this equipment will be further handled during the recycling process, so please be considerate when depositing your equipment. Please contact the local council for details of your local household waste recycling centre.



www.altimo.co.uk

For customer service call: 0330 041 7490